

RESOLUTION NO. 29519

A RESOLUTION AUTHORIZING THE ADMINISTRATOR FOR THE DEPARTMENT OF TRANSPORTATION TO ENTER INTO AN AGREEMENT WITH BROWN BROTHERS, INC. RELATIVE TO CONTRACT NO. T-17-010-201 FOR CONSTRUCTION SERVICES ASSOCIATED WITH PASSENGER STREET RECONSTRUCTION, IN THE AMOUNT OF TWO HUNDRED SEVENTY-EIGHT THOUSAND SEVEN HUNDRED FORTY-EIGHT AND 32/100 DOLLARS (\$278,748.32), WITH A CONTINGENCY AMOUNT OF TWENTY-SEVEN THOUSAND EIGHT HUNDRED SEVENTY-FOUR AND 83/100 DOLLARS (\$27,874.83), FOR A TOTAL AMOUNT OF THREE HUNDRED SIX THOUSAND SIX HUNDRED TWENTY-THREE AND 15/100 DOLLARS (\$306,623.15).

BE IT RESOLVED BY THE CITY COUNCIL OF THE CITY OF CHATTANOOGA,
That it is hereby authorizing the Administrator for the Department of Transportation to enter into an agreement with Brown Brothers, Inc. relative to Contract No. T-17-010-201 for construction services associated with Passenger Street Reconstruction, in the amount of \$278,748.32, with a contingency amount of \$27,874.83, for a total amount of \$306,623.15.

ADOPTED: July 3, 2018

/mem

Exhibit 'A'

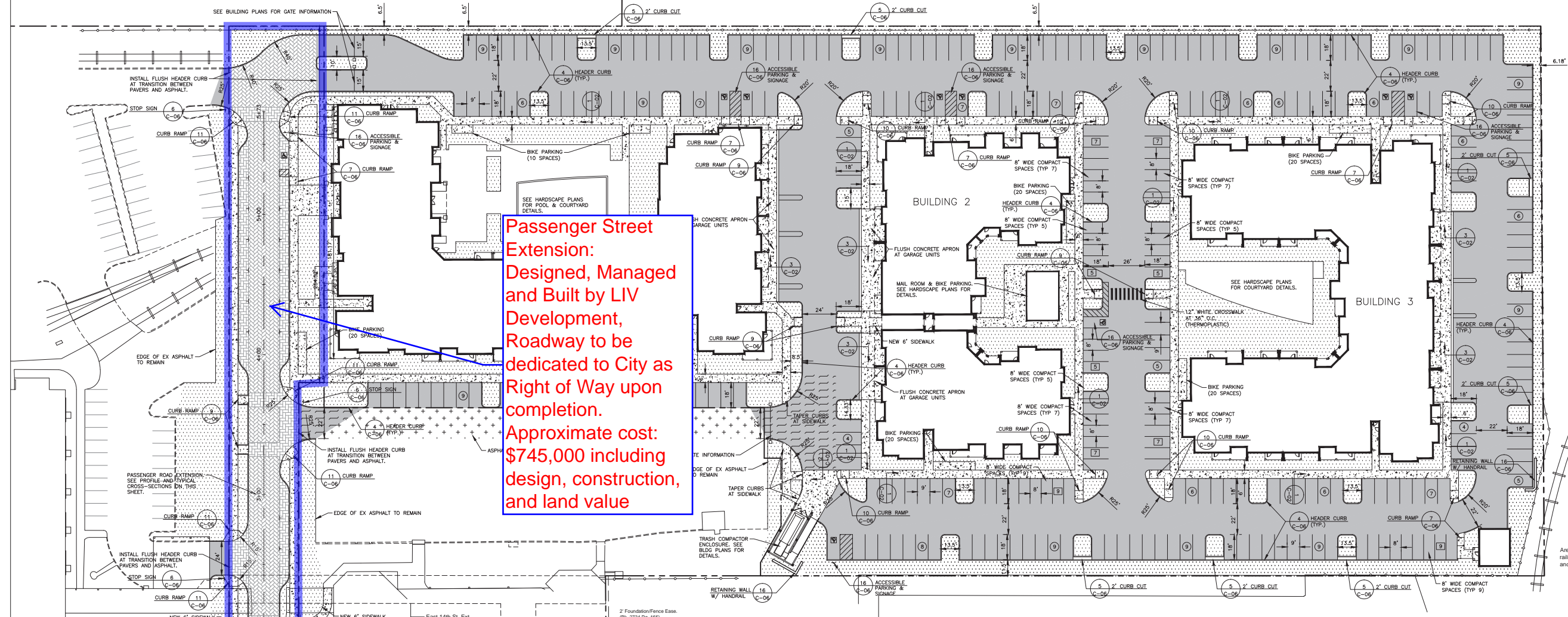

Passenger Street Extension:
 Designed, Managed and Built by LIV Development, Roadway to be dedicated to City as Right of Way upon completion.
 Approximate cost: \$745,000 including design, construction, and land value

Passenger Street Reconstruction:
 Design provided by LIV Development, City funded and Managed. All work to be performed within existing City Right of Way.

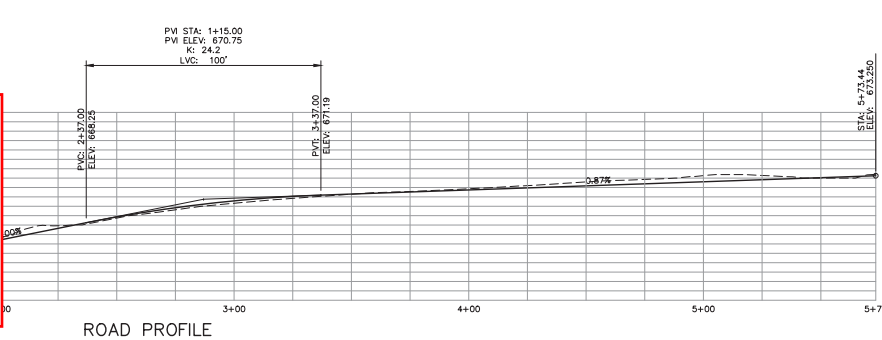

PARKING & PAVING LEGEND	
PROPERTY LINE	---
CONCRETE CURB	=====
EXISTING CURB	-----
DIRECTIONAL ARROW, PAINTED WHITE	→
TRAFFIC SIGN	⊠
LANDSCAPE AREA/ SODDED AREAS (SEE LANDSCAPE PLANS)	▨
CONCRETE	▩
PAVERS (BELGRAD AQUA-BRIC, 45° HERRINGBONE, COLOR-ARDENNES)	▧
PAVERS (BELGRAD AQUA-BRIC, 90° HERRINGBONE, COLOR-FOSSIL BEIGE)	▦
STANDARD DUTY PAVEMENT	▤
HEAVY DUTY PAVEMENT	▥
1" OVERLAY	▣
LIGHT POLE (SEE SITE ELECTRICAL PLANS)	⊞
STANDARD PARKING (9' WIDE)	▢
COMPACT PARKING (8' & 8.5' WIDE)	▣

PARKING AND PAVING NOTES

- ALL WORK SHALL COMPLY WITH ALL APPLICABLE CODES, REGULATIONS, AND/OR LOCAL STANDARDS IMPOSED BY LOCAL UTILITY, CITY, COUNTY, AND STATE. IT IS THE CONTRACTOR'S RESPONSIBILITY THAT ALL THE CONSTRUCTION BE IN ACCORDANCE WITH THE CITY OF CHATTANOOGA AND TDOT STANDARD DETAILS AND SPECIFICATIONS.
- CONTRACTOR SHALL COMPLY WITH ALL PERTINENT PROVISIONS OF THE "MANUAL OF ACCIDENT PREVENTION IN CONSTRUCTION" ISSUED BY AGC OF AMERICA, INC., AND THE SAFETY AND HEALTH REGULATIONS FOR CONSTRUCTION ISSUED BY THE U.S. DEPARTMENT OF LABOR.
- CONTRACTOR SHALL PROVIDE ALL NECESSARY BARRICADES, SUFFICIENT LIGHTS, SIGNS AND OTHER TRAFFIC CONTROL DEVICES AS MAY BE NECESSARY FOR THE PROTECTION AND SAFETY OF THE PUBLIC AND SHALL BE PROVIDED AND MAINTAINED THROUGHOUT ALL CONSTRUCTION ADJACENT TO AND WITHIN ALL ROADWAYS. CONTRACTOR SHALL SUBMIT TRAFFIC CONTROL PLAN TO CITY AND STATE FOR APPROVAL. THE CONTRACTOR SHALL TAKE NECESSARY MEASURES TO SEPARATE WORK AREAS FROM PEDESTRIAN TRAFFIC AND TO INSURE SAFE PEDESTRIAN PASSAGE AT ALL TIMES.
- ALL SIGNS, PAVEMENT MARKINGS, AND OTHER TRAFFIC CONTROL DEVICES SHALL CONFORM TO THE MANUAL ON UNIFORM TRAFFIC CONTROL DEVICES. A MINIMUM CLEARANCE OF TWO FEET SHALL BE MAINTAINED BETWEEN THE FACE OF CURB AND ANY PART OF A TRAFFIC SIGN OR LIGHT POLE. CONTRACTOR SHALL COORDINATE INSTALLATION OF ALL SIGNS, PAVEMENT MARKINGS, AND OTHER TRAFFIC CONTROL DEVICES WITH OTHER CONTRACTORS ON SIGNS OR LIGHT POLES.
- CONTRACTOR SHALL FURNISH AND INSTALL ALL PAVEMENT MARKINGS AS SHOWN. ALL PAVEMENT MARKINGS SHALL BE FOUR (4") WIDE SOLID WHITE UNLESS INDICATED OTHERWISE ON THE DRAWINGS. PAINT SHALL BE APPLIED IN TWO COATS FOR A MINIMUM DRY FILM THICKNESS OF 15 MIL. THERMOPLASTIC STRIPING, IF REQUIRED, SHALL BE SPRAY TYPE, APPLIED IN ACCORDANCE WITH DOT STANDARDS.
- CONTRACTOR SHALL SAW-CUT TO PROVIDE SMOOTH TRANSITIONS AT TIE-INS TO EXISTING EDGES OF PAVEMENT AND AT COLD JOINTS OF RECENTLY PAVED ASPHALT.
- JOINTS OR SCORE MARKS ARE TO BE SHARP AND CLEAN WITHOUT SHOWING EDGES OF JOINTING TOOL. CONTRACTOR SHALL SAW-CUT TIE-INS AT EXISTING CURBS AS NECESSARY TO ENSURE SMOOTH TRANSITIONS. CONTRACTOR SHALL SAW-CUT AND TRANSITION TO MEET EXISTING PAVEMENT AS NECESSARY AND AS DIRECTED BY INSPECTOR TO INSURE POSITIVE DRAINAGE. (TYPICAL @ ALL INTERSECTIONS)
- PAVING CONTRACTOR SHALL INSTALL PAPER BREAKAWAY EDGES AT COLD JOINTS OR SAWCUT AS REQUIRED TO INSURE A STRAIGHT, FULL-DEPTH JOINT FACE IMMEDIATELY PRIOR TO INSTALLING ABUTTING HOT ASPHALT.
- ALL DIMENSIONS ARE TO FACE OF CURB UNLESS INDICATED OTHERWISE.
- CONTRACTOR SHALL BE RESPONSIBLE FOR COST OF PAVEMENT REPLACEMENT WHERE UTILITY LINES ARE EXTENDED ACROSS EXISTING ASPHALT.
- ASPHALT SURFACE COURSE SHALL BE LAID WITH THE DIRECTION OF TRAFFIC IN ALL DRIVE LANES WITHIN PARKING FIELDS.
- BASE AND ASPHALT THICKNESSES ARE MINIMUM REQUIRED. REFER TO SPECIFICATIONS FOR TYPE OF PAVING AND BASE TO BE USED.
- ALL CONCRETE SHALL BE CLASS 4000 P.S.I. UNLESS NOTED OTHERWISE. DO NOT POUR ANY CONCRETE BEFORE FORMS ARE INSPECTED AND APPROVED BY THE INSPECTOR.
- ALL RAMPS CONSTRUCTED ARE NOT TO EXCEED A SLOPE OF 1:12. ALL SIDEWALKS SHALL NOT HAVE A CROSS-SLOPE GREATER THAN 1:50.
- CONCRETE DUMPSTER PADS TO BE FLUSH WITH PAVEMENT UNLESS INDICATED OTHERWISE.
- SEE SHEET C-06 FOR ADDITIONAL DETAILS ON STRIPING, SIGNS, ETC.

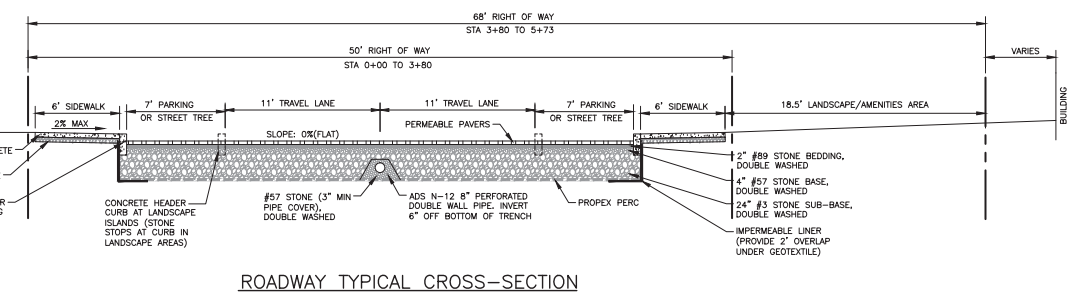

ROADWAY TYPICAL CROSS-SECTION

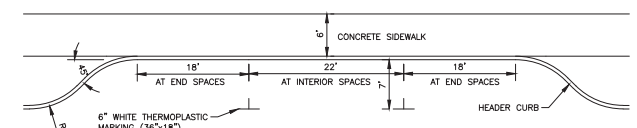

PARALLEL PARKING DETAIL

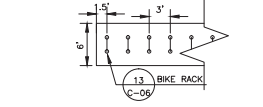

BICYCLE PARKING DETAIL

1 SIDEWALK TURNDOWN N.T.S.

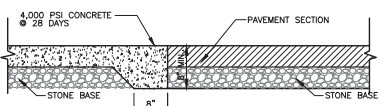

2 TURNDOWN DETAIL N.T.S.

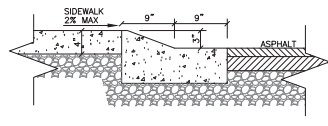

3 MOUNTABLE CURB N.T.S.

BERRY ENGINEERS LLC
 CIVIL ENGINEER
 155 KENTUCKY SUITE 100
 CLEVELAND, TN 37312
 TEL: (423) 7968880

CHARLAN BROCK & ASSOCIATES
 ARCHITECT
 1770 FENNELL ST
 MAITLAND, FL 32751
 (407) 660-8900

LIV DEVELOPMENT
 DEVELOPER
 2204 LAKESHORE DR, SUITE 450
 BIRMINGHAM, AL 35209

BLUEBIRD ROW APARTMENT COMPLEX
 PROJECT
 PASSENGER ST
 CHATTANOOGA, TN



REVISIONS		
1	BULLETIN #1	05/11/17
2	BULLETIN #2	06/27/17
3		
4		
5		
6		
7		
8		
9		
10		

SHEET NAME:
 SITE LAYOUT & PAVING PLAN
 DATE: 04/19/2017
 DRAWN BY: BMB
 CHECKED BY: CMB
 PROJECT NO.: 16074
 SHEET NUMBER:
C-02

